

LINIX[®]

步进电机
STEPPING MOTOR

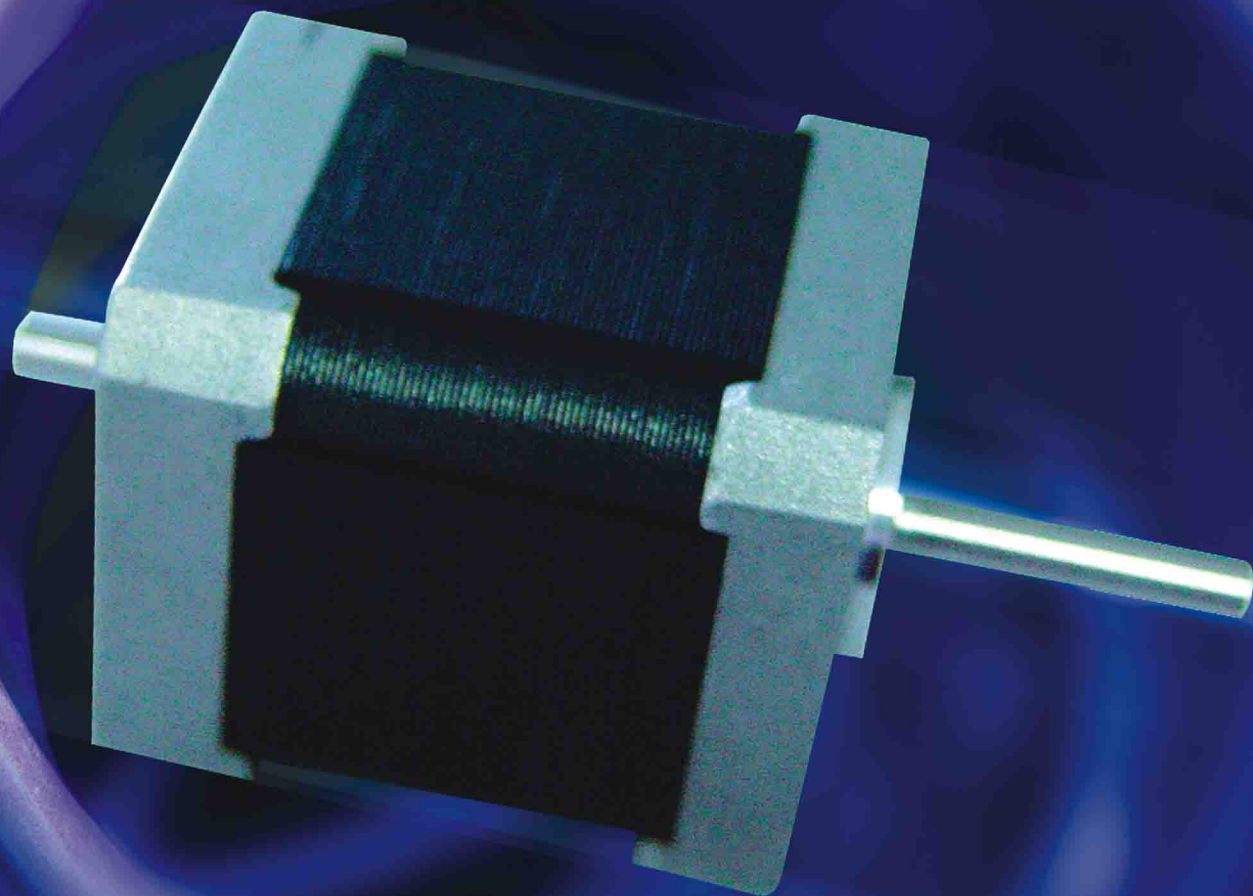

57 **BYG** **(H)** **S** **4** **51** **(01)** / **60JB**

57=57mm
42=42mm

H: quadrate frame,
else circular frame

Code of gear head

BYG: Stepping motor

Frame length Derivative code

Cold insulation resistance of the conductive part of the motor to the housing is no less than $100M\Omega$

Insulation Dielectric strength: the conductive part and the housing of the motor withstand 500V lasting 1min. for pressureproof experiment but can not be punctured

Temperature rise: $<70K$

Noise: $<50dB$

Altitude within 2500m

Ambient temperature: $-c.20^{\circ}C \sim 60^{\circ}C$

Relative humidity $\leq 90\%$ (temperature $20^{\circ}C$)

Ambient temperature: $-b.5^{\circ}C \sim 35^{\circ}C$

Relative humidity $\leq 70\%$

Good ventilation

No corrosive gas present

No strong magnetite object present

to be sure input voltage grading correct

With loading the output axle is prohibited to thrum and extrude strongly to avoid internal deformation which bring on noise and antiseize

42BYGH



Type	Voltage V	Current A	Phase	L mm	Resistance Ω	Hold torque Kg cm	Lead wire
42BYGHD233	24	0.4	2	33	30	2.0	4
42BYGHS444	24	0.3	4	44	30	2.8	6
42BYGHS239	24	0.4	2	39	15	2.0	4
42BYGHD248/70JB	24	0.8	2	48	5	3.2	4
42BYGHS248	24	0.4	2	48	15	3.4	4
42BYGHD24801	24	0.4	2	48	30	3.2	4

Step angle	Insulation resistance	Insulation strength	Ambient temperature	Temperature rise	Radial jumpiness	Axial jumpiness
		50Hz 1Minute 500V Min			0.02mm Max.	0.1-0.3mm

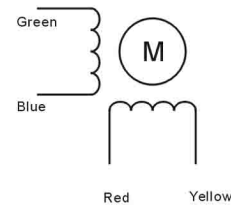
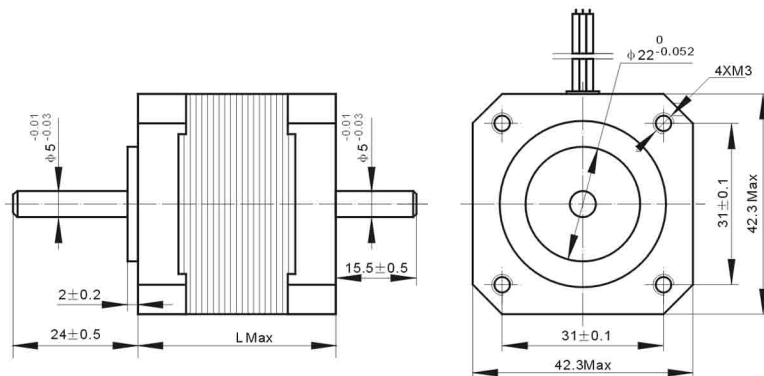

Four lead wires

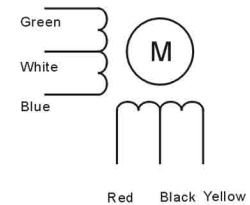

Six lead wires

Every standard offering can be designed and tailored to meet your specific needs.

Featured with high torque, quiet, smooth running, it is popularly applied to numerically controlled machine, embroidery machine, computerized knitting machine, optical apparatus, medical equipment.

57BYG



Type	Voltage V	Current A	Phase	L mm	Resistance Ω	Hold torque Kg cm	Lead wire
57BYGS456	24	1.2	4	56	5	6.0	6
57BYGS45601	24	2.4	4	56	1	6.0	6
57BYGS451	24	1.2	4	51	15	5.5	6

Step angle	Insulation resistance	Insulation strength	Ambient temperature	Temperature rise	Radial jumpiness	Axial jumpiness
		50Hz 1Minute 500V Min			0.02mm Max.	0.1-0.3mm

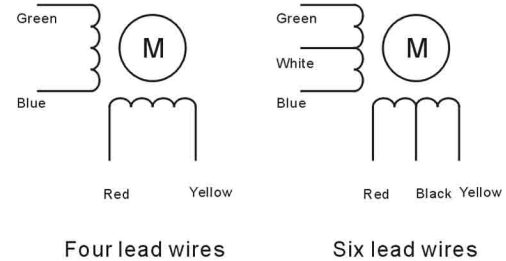
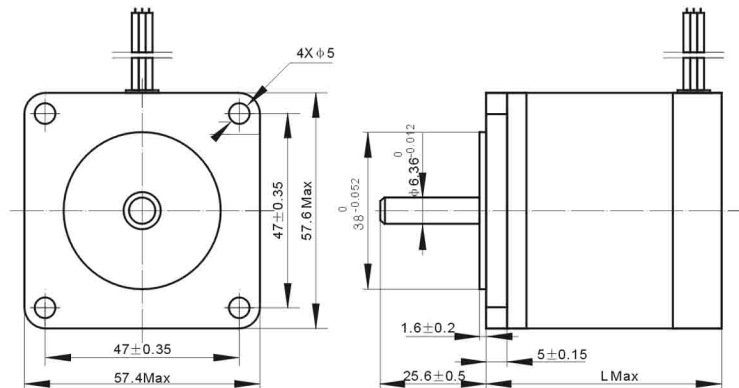

Every standard offering can be designed and tailored to meet your specific needs.

Featured with high torque, quiet, smooth running, it is popularly applied to numerically controlled machine, embroidery machine, computetrized knitting machine, optical apparatus, packing machine, medical equipment.

57BYGH



Type	Voltage V	Current A	Phase	L mm	Resistance Ω	Hold torque Kg cm	Lead wire
57BYGHS454	24	2.4	4	54	20	6.0	6
57BYGHS451/60JB	24	0.8	4	51	30	6.0	6
57BYGHS441	24	0.5	4	41	30	5.5	6
57BYGHS473	24	2.4	4	73	1	15	6
57BYGHD454	3.6	2	4	54	1.8	8.0	6
57BYGHD460	3.6	2	4	60	1.8	9.0	6

Step angle	Insulation resistance	Insulation strength	Ambient temperature	Temperature rise	Radial jumpiness	Axial jumpiness
		50Hz 1Minute 500V Min			0.02mm Max.	0.1-0.3mm

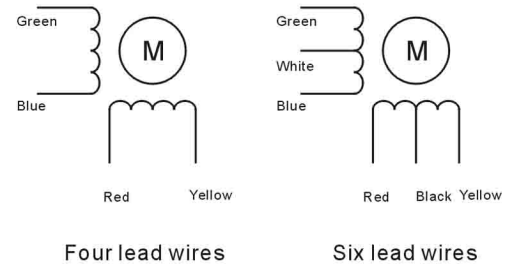
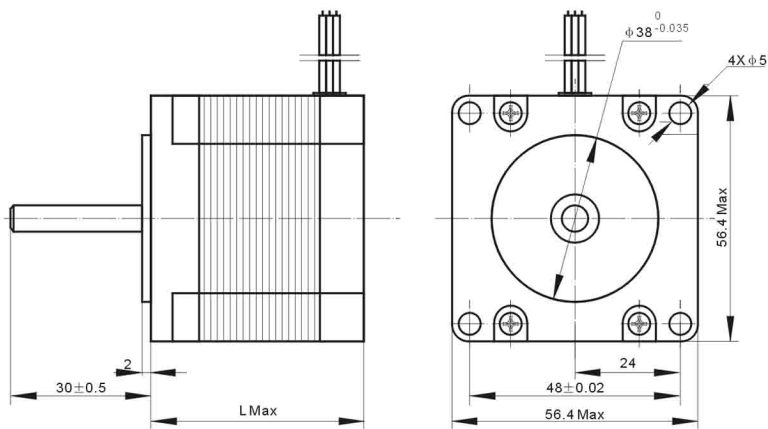

Every standard offering can be designed and tailored to meet your specific needs.

Featured with high torque, quiet, smooth running, it is popularly applied to numerically controlled machine, embroidery machine, computetrized kintting machine, packing machine, medical equipment.

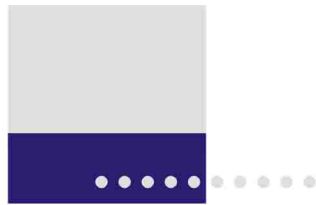

Type	Voltage V	Current A	Phase	L mm	Resistance Ω	Hold torque Kg.cm	Lead wire
57BYGHS451/60JB	24	0.8	4	51	30	6.0	6
42BYGHS248/70JB	24	0.8	2	48	5	3.2	4

Step angle	Insulation resistance	Insulation strength	Ambient temperature	Temperature rise	Radial jumpiness	Axial jumpiness
		50Hz 1Minute 500V Min	.		0.02mm Max.	0.1-0.3mm

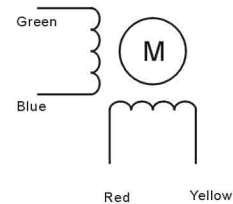
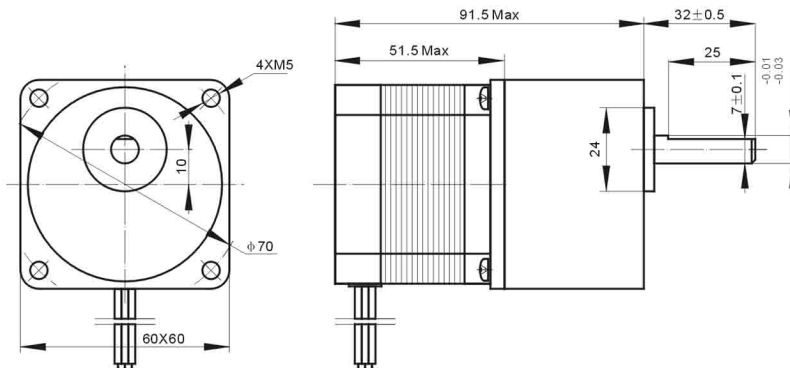

Four lead wires

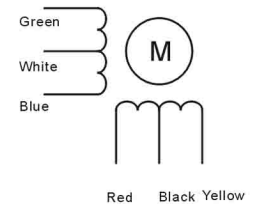

Six lead wires

Every standard offering can be designed and tailored to meet your specific needs.

The reduction stepping motor is popularly applied to numerically controlled machine, optical apparatus, medical equipment and other industrial automation equipment with high precision.

LINIX[®] Since 1968

Hot line:0579-6622113(10lines)

HENGDIAN GROUP LINIX MOTOR CO.,LTD.

Add.: No.96 Renmin Rd., Dongyang, Zhejiang

China 322100

Tel: +86-579-6630197

Fax: +86-579-6630757

E-mail: 031@linix.com.cn (Ying Honghui)

Website: <http://www.eastsources.com>